



## Survey of "Addition to Peter's Lott" for Peter Gordy II

Peter Gordy I received a common warrant for "Addition to Peter's Lott" containing 50 acres in Worcester County Maryland on 14 December 1755. On 21 March 1759 a survey of the land was recorded and he assigned the warrant to his son, Peter Gordy II. The document includes the survey description and plat. We do not have the citation information.

Facsimile of this document

Transcription of this document is not yet available.

Return to the [Original Documents Index](http://www.gordyfamily.org/genealogy/origdocs-index.html) at GordyFamily web site.  
<http://www.gordyfamily.org/genealogy/origdocs-index.html>

Plantation when on the now line thence running N. 55. W. 200 p. thence S. 8. E. 70 p.  
 N. 73. E. 123 p. thence S. 35. E. 40 p. thence S. 82. W. 24 p. thence S. E. 17 p. thence  
 S. 50. W. 24 p. thence S. 30. E. 106 p. thence S. 37. W. 42 p. thence S. 43. E. 126 p. thence  
 S. 64. W. 32 p. thence as a right line to the first boundary containing and  
 now laid out for 144. ac. of Land more or less **Discovered** Discovery and  
 Venture to be holden of the Mannour of Worcester

This Plot laid down of 100 p. in the  
 by a scale of 100 p. in the inch  
 N. 55. W. 200  
 S. 30. E. 106  
 S. 37. W. 42  
 S. 64. W. 32  
 S. 43. E. 126  
 S. 82. W. 24  
 S. 73. E. 123  
 S. 50. W. 24  
 S. 35. E. 40  
 S. 8. E. 70  
 as a right line

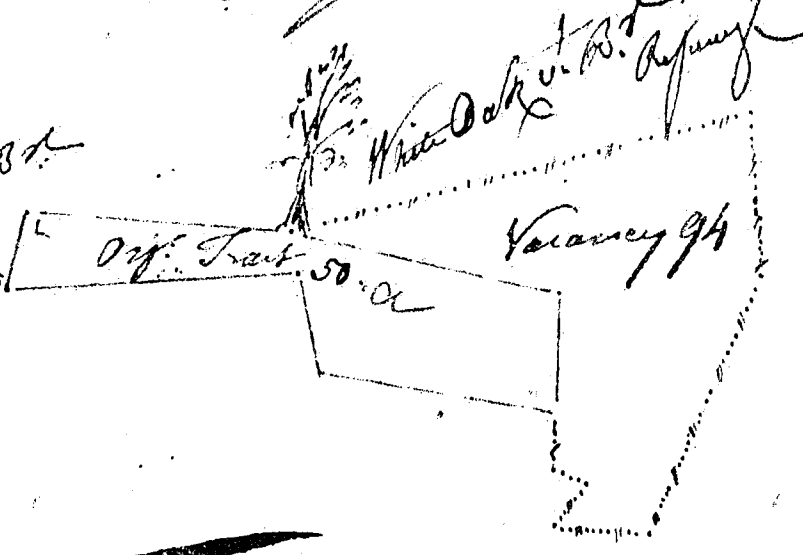

Maryland 1755

Apr 23 1755

By virtue of a Comon Warrant granted unto Peter Gandy Junr of Warrick  
 for 50 ac. of Land bearing date of 14. day of Decr. Anno: Domini: 1755  
 which S. Warrant is as ye. over unto Peter Gandy Junr of the Co. of  
 these are returned by to wit: that J. John Perry Senr. Senr. Warrick under the  
 name of Benj. T. Tucker Junr. have awarded by Senr. G. Landact for the Co.  
 Peter Gandy Junr. that part or parcel of Land addition to Peter Gandy Junr.  
 lying & being in the Co. of Warrick: as follows **Red Oak** & a small  
 tree standing on the brow of a hill near a small open field upon Hamby  
 Dunes on the South side of Daniel Melhams Plantation & on the N. E. side of  
 Run Ridge thence running N. 55. E. 90 p. thence N. . . 90 p. thence  
 N. 73. W. 90 p. thence as a right line to the first boundary containing  
 & now laid out for 50 ac. of Land more or less to be holden of the  
 Mannour of Worcester

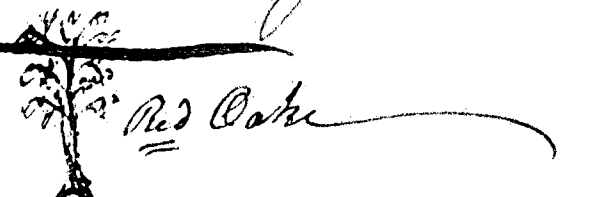

This Plot laid down  
 of 50 p. in the inch

addition to Peter Gandy  
 50 ac

Witness Peter Gandy Junr. by Peter Gandy  
 Warrick 22 Apr. 1755  
 Test: James Brown